

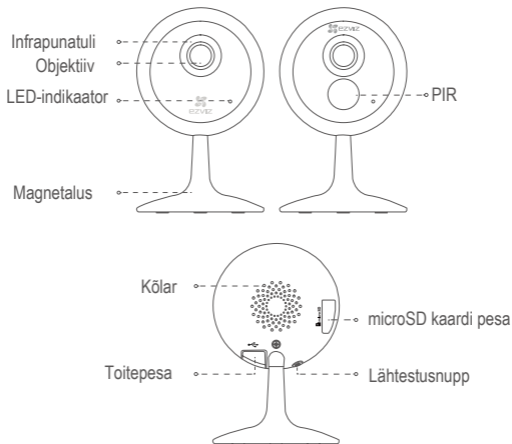

Kiirjuhend Quick Start Guide

www.ezvizlife.com

Üldine



Nimetus

LED-
indikaator

Kirjeldus

- Pidevalt põlev punane tuli: Kaamera käivitub.
- Aeglaselt vilkuv punane: Wi-Fi ühenduse probleem.
- Kiirelt vilkuv punane: Kaamera probleem (nt MicroSD kaardi tõrge).
- Pidevalt põlev sinine tuli: EZVIZ rakendusest vaadatakse videot.
- Kiirelt vilkuv sinine: Kaamera on Wi-Fi ühenduse loomiseks valmis.
- Aeglaselt vilkuv sinine: Kaamera töötab tõrgeteta.

microSD
kaart

Lähtestus-
nupp

microSD peab ostma eraldi. Lähtesta kaart enne kasutamist EZVIZi rakenduses.

Kui töötava kaamera lähtestusnupu 5 sekundit all hoida, siis kaamera taaskäivitub ja taastatakse tehaseseaded.

Pakendi sisu



Võrgukaamera (x1)



Vahtkleeps (x2)



USB-juhe (x1)



Metallplaat (x1)
(3,5 mm augu läbimõõt)



Toiteadapter (x1)



Kiirjuhend (x1)

i Kaamera välimus sõltub ostetud mudelist.

Seadistamine

Samm 1 Sisse lülitamine

Ühenda adapteri toitejuhe kaameraga ja seejärel ühenda adapter seinapistikusse, nagu on näidatud joonisel.

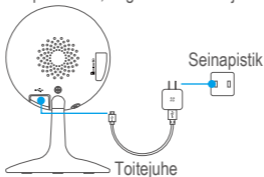

Samm 2 Kaamera seadistamine

1. Loo kasutajakonto.

- Ühenda mobiiltelefon juhtmevaba 2.4GHz võrguga.
- Leia App Store'i või Google Play(TM) veebipoest EZVIZi rakendus. Paigalda see.
- Käivita rakendus ja registreeri EZVIZi kasutajakonto, järgides paigaldusviisardi juhiseid.

2. Lisa EZVIZi rakenduses kaamera

- Logi EZVIZi rakendusse sisse.
- Toksa QR-koodi skaneerimise liidese avamiseks kodulekraani ülemises paremas nurgas olevat "+" sümboolit.



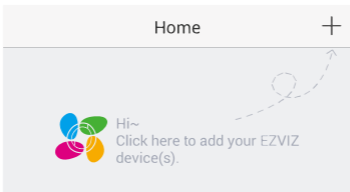

Skaneeri kaamera jala all olev QR-kood.

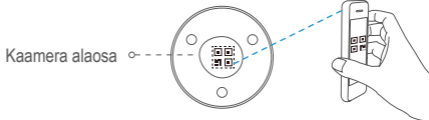

- Järgi seadistamise lõpetamiseks EZVIZi viisardi juhiseid.

 Veendu, et sinu mobiiltelefon on ühendatud 2.4GHz Wi-Fi võrku (näeb Wi-Fi seadetest).

Paigaldamine

Samm 1 Paigalda metallplaat (valikuline)

Vali puhas ja tasane pind ning kinnita metallplaat vahtklepsude või kruvide (pole komplektis) abil soovitud kohta.

- i** Kaamera sees on magnet - selle sammu võib metallpinnale paigaldamisel vahele jätta.

Samm 2 Paigalda kaamera

Paigalda kaamera magneti abil metallplaadi või metallpinna külge (vt joonist).

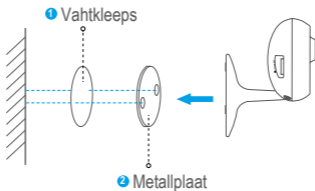

Samm 3 Paigaldamise lõpetamine

Muuda kaameranurka vastavalt vajadusele.

Basics

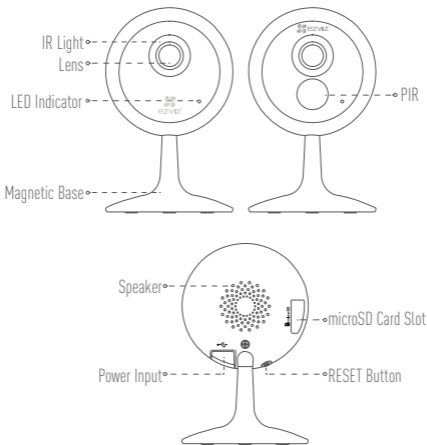

Name	Description
LED Indicator	<ul style="list-style-type: none">• Solid Red: Camera is starting up.• Slowly Flashing Red: Wi-Fi connection has failed.• Fastly Flashing Red: Device exception (e.g. microSD card error).• Solid Blue: Video is being viewed or played back in EZVIZ App.• Fastly Flashing Blue: Camera is ready for the Wi-Fi connection.• Slowly Flashing Blue: Camera is running properly.
microSD Card	microSD Card should be purchased separately. Initialize the card in the EZVIZ app before using it.
RESET Button	Hold down the RESET button for 5 seconds while the camera is running, the camera restarts and all parameters are reset to default.

Box Content



Internet Camera (x1)



Foam Sticker (x2)



USB Cable (x1)



Metal Plate (x1)
(3.5mm Hole Diameter)



Power Adapter (x1)



Quick Start Guide (x1)

i The camera appearance is subject to the actual one you have bought.

Setup

Step 1 Power-on

Plug the power cable into the camera and to the power adapter and then into a power outlet, as shown in the figure below.

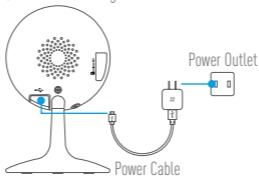

Step 2 Camera Setup

1. Create a user account

- Connect your mobile phone to Wi-Fi.
- Download and install the EZVIZ app by searching "EZVIZ" in App Store or Google Play™.
- Launch the app and register for an EZVIZ user account following the start-up wizard.



2. Add a camera to EZVIZ

- Log in the EZVIZ app.
- From the EZVIZ app Home screen, tap "+" on the upper-right hand corner to go to the scan QR code interface.

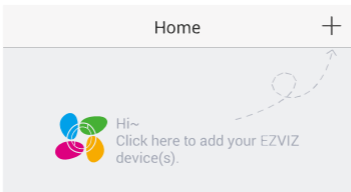

- Scan the QR Code on the bottom of the camera.

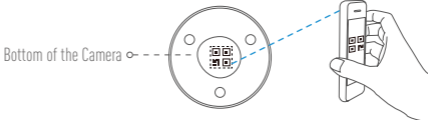

- Follow the EZVIZ app wizard to finish Wi-Fi configuration.

 Please make sure your phone is connected to the 2.4GHz Wi-Fi from the router for Wi-Fi configuration.

Installation

Step 1 Install the Metal Plate (Optional)

Pick a clean and flat surface and secure the metal plate to the desired position with the foam stickers or screws (not included).

- i** There's a magnet piece inside the camera. You can skip this step if the surface is made of metal.

Step 2 Install the Camera

Secure the camera magnetically to the metal plate or metal surface (see figure below).

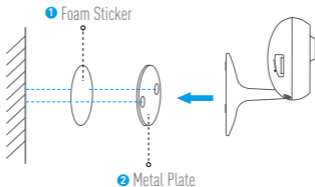

Step 3 Completing Installation

Adjust the camera angle as required.



UD13523B-A